

building layout

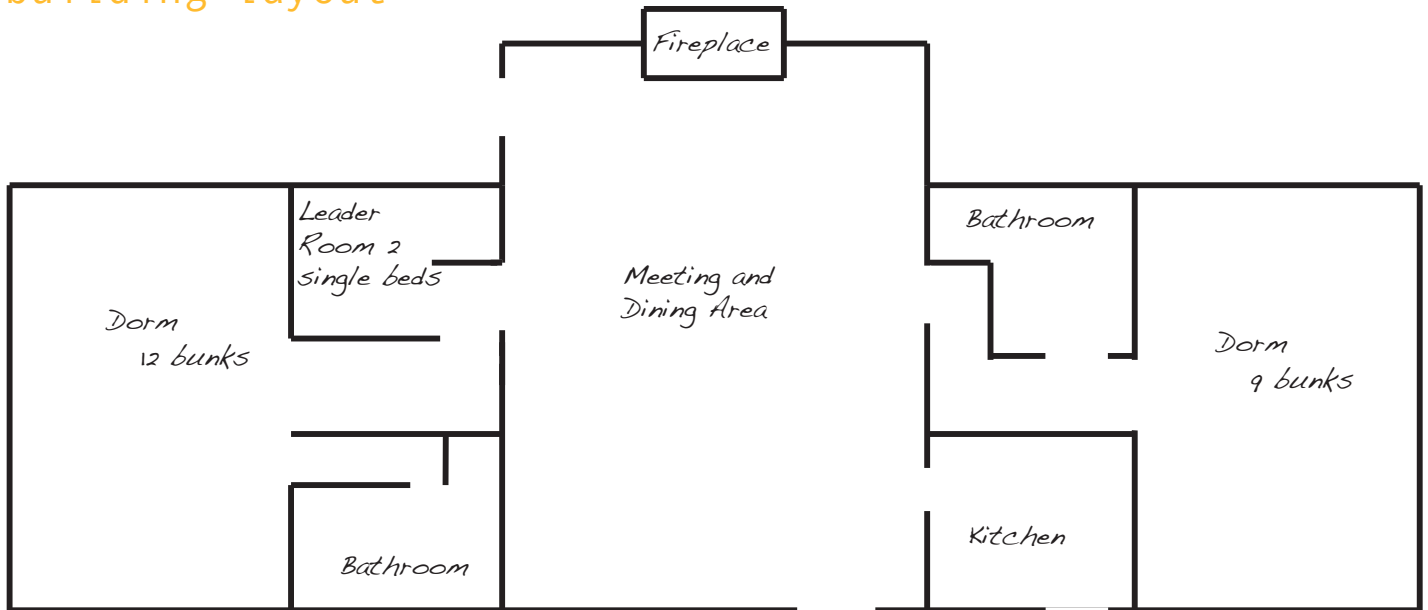

balancing gender ratios

NOTES ON BALANCING LEADER AND GENDER RATIOS IN THE CABIN.

You are free to balance however works best. That Thing recommends a 1:10 leader ratio

room	bed spaces	used for
dorm 1	24	students/leaders
dorm 2	18	students/leaders
counselor room	2	leaders

analyzing ticket averages

The Most Cost Effective Ticket

The way to build the cheapest cost on a ticket is in securing the largest capacity lodge and filling it to capacity. Since the building has a flat rate, bringing less students makes the average cost of a ticket increase.

How to Charge Students

This process seems to be unique to each group at That Thing. We would recommend the following.

You've hopefully chosen a cabin you believe you can fill 100%, so filling it to around 75% should be very do-able. *(in blue)*

Communicate and charge the 75% fee to your students and families. When you pass that capacity, you can then give a rebate back to the families (this can even be a recruiting incentive for the students/parents) or you can then take care of all food costs with that money or you could put that money into scholarships for students who would need it.

Posting Extra Tickets

Don't forget to post your open bunks in a timely manner in order for groups to make the connection. The price you choose to charge them for the tickets and food is entirely at your discretion.

# of students	ticket average
39	\$226
36	\$244
33	\$267
31	\$284
29	\$304