

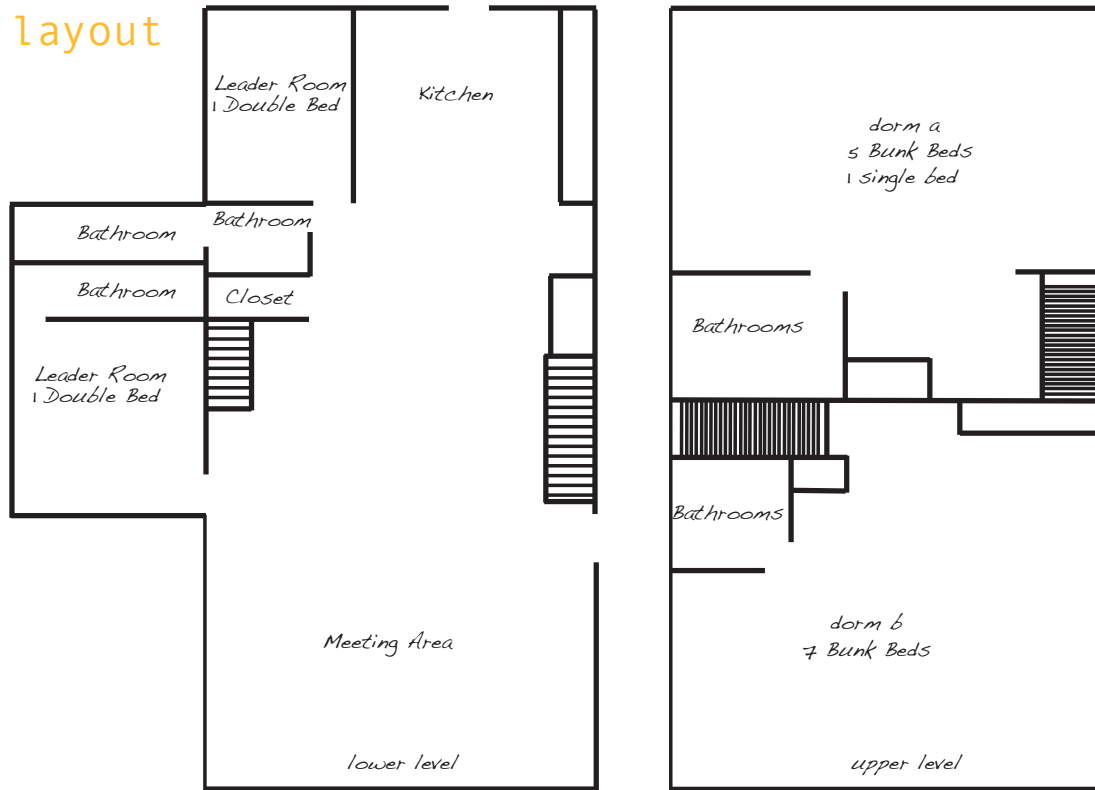

# North Star Lodge

Epworth Forest CC

## building layout



## balancing gender ratios

NOTES ON BALANCING LEADER AND GENDER RATIOS IN THE CABIN.

You are free to balance however works best. That Thing recommends a 1:10 leader ratio

room	bed spaces	used for
dorm a	11	students/leaders
dorm b	14	students/leaders
leader rooms	2	leaders

## analyzing ticket averages

### The Most Cost Effective Ticket

The way to build the cheapest cost on a ticket is in securing the largest capacity lodge and filling it to capacity. Since the building has a flat rate, bringing less students makes the average cost of a ticket increase.

### How to Charge Students

This process seems to be unique to each group at That Thing. We would recommend the following.

You've hopefully chosen a cabin you believe you can fill 100%, so filling it to around 75% should be very do-able. *(in blue)*

Communicate and charge the 75% fee to your students and families. When you pass that capacity, you can then give a rebate back to the families (this can even be a recruiting incentive for the students/parents) or you can then take care of all food costs with that money or you could put that money into scholarships for students who would need it.

### Posting Extra Tickets

Don't forget to post your open bunks in a timely manner in order for groups to make the connection. The price you choose to charge them for the tickets and food is entirely at your discretion.

# of students	ticket average
24	\$243
22	\$265
21	\$278
19	\$307
18	\$324